



① Hatchways

OSHA considers hatches to be holes one can fall through so they must have fall prevention equipment on three sides and accessed via a self-closing gate.

③ Skylights and Smoke Hatches

Skylights are considered holes by OSHA so they need covers to protect workers from falling to a lower level.

② Serviceable Equipment

Equipment such as HVAC, drains, scuppers, security systems, telecom equipment or lighting that needs regular maintenance and is within 6 feet of the fall edge, needs fall prevention equipment to protect workers.

④ Fixed Ladders

If a fixed ladder is used to access an upper level and that level is 4 feet above the lower level, fall prevention is needed to protect workers as they step onto the upper level.



Why Choose Garlock Safety Systems?

- Rigorously Tested to Exceed OSHA & ANSI Standards
- In-House Engineering
- Full Passive Fall Prevention Portfolio
- Custom Engineered Products Available

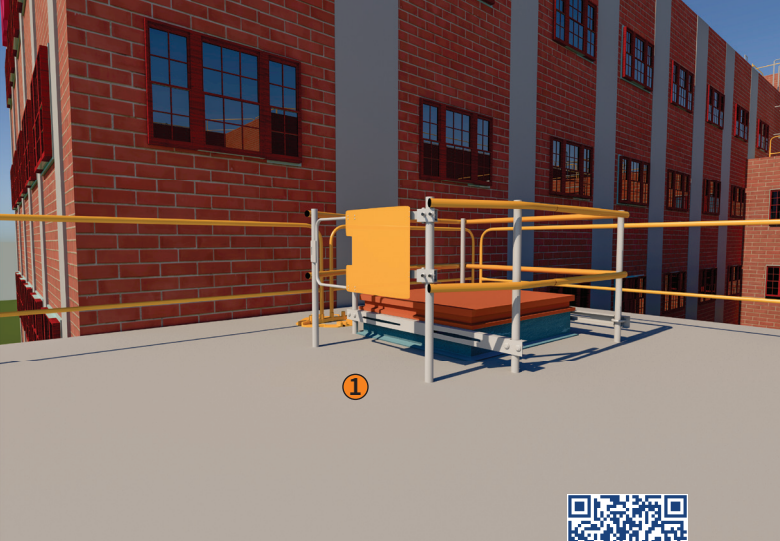

① HatchProtector™

The HatchProtector is like a guardrail system for access hatches except also features a self closing gate to exit the hatch.

- Installs quickly with simple hand tools, no drilling required
- Adjustable in length and width for a perfect fit



② RailGuard 200™ Safety Guardrail

Non-penetrating weighted bases and guardrail prevents people from falling.

- Non-penetrating, maintains a water tight roof
- No tools or drilling required
- A wide selection of accessories available

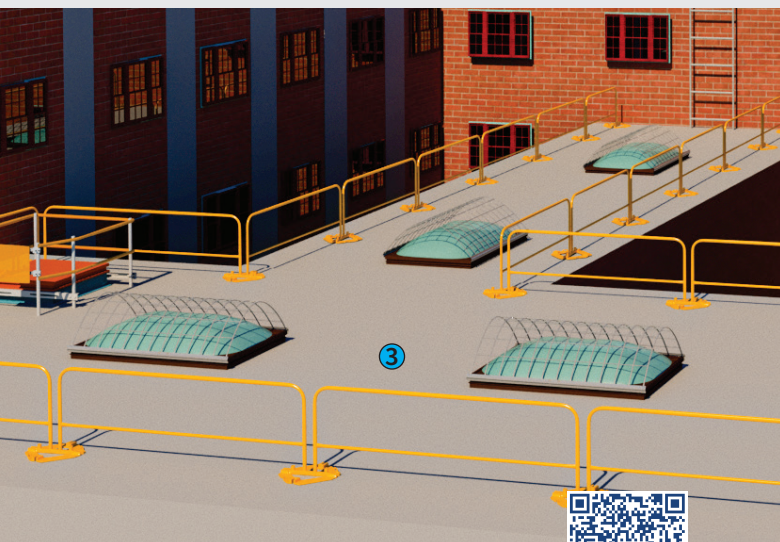

③ ScreenGuard™ Skylight Covers

ScreenGuard is an economical way to prevent people from falling through skylights.

- Non-penetrating into the roof or skylight curb
- Galvanized plated, for use on low domed skylights
- Meets federal and CAL OSHA requirements



④ LadderGuard™

LadderGuard escorts people onto the roof 6 feet away from the roof edge.

- Keep workers safe when you have fixed ladders on the roof
- Included ladder connector closes off the fall hazard between the ladder and rails

