



① Hatchways

OSHA considers hatches to be holes one can fall through so they must have fall prevention equipment on three sides and accessed via a self-closing gate.

② Serviceable Equipment

Equipment such as HVAC, drains, scuppers, security systems, telecom equipment or lighting that needs regular maintenance and is within 6 feet of the fall edge, needs fall prevention equipment to protect workers.

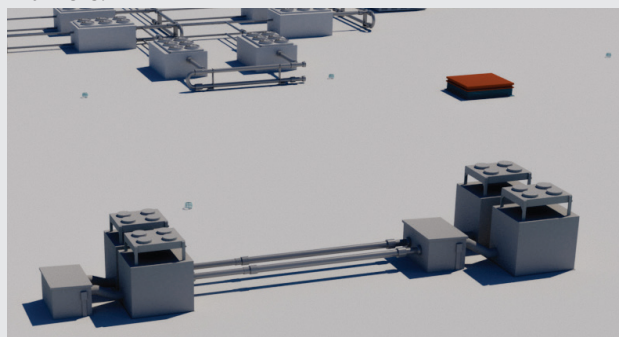

③ Step Over Hazard

Manufacturing facilities often have pipes, conduits, and other obstacles that need to be crossed over. These can pose trip hazards if stepped over or other injuries if people try to go underneath them.

④ Elevated Shipping and Receiving dock Areas

Shipping and receiving docks that are greater than 4 feet above ground level must be protected with fall prevention equipment.



Why Choose Garlock Safety Systems?

- Rigorously Tested to Exceed OSHA & ANSI Standards
- In-House Engineering
- Full Passive Fall Prevention Portfolio
- Custom Engineered Products Available

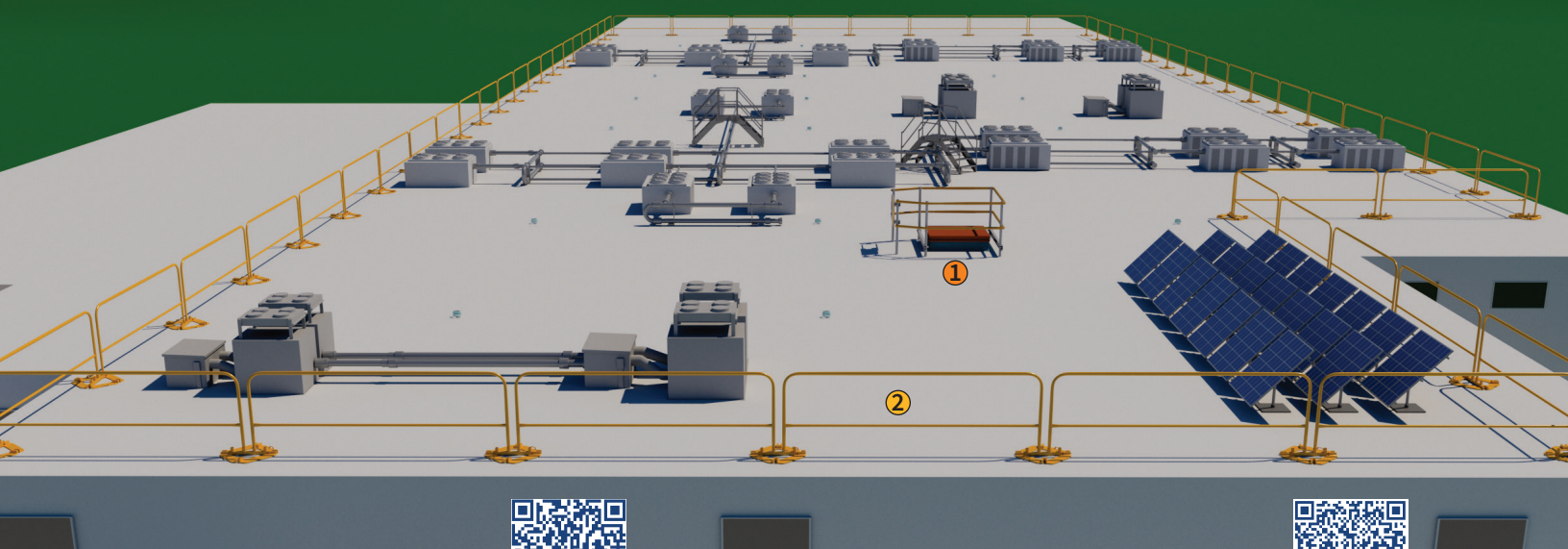

① HatchProtector™



The HatchProtector is like a guardrail system for access hatches except also features a self closing gate to exit the hatch.

- Installs quickly with simple hand tools, no drilling required
- Adjustable in length and width for a perfect fit
- Multiple sizes are available to fit almost any hatch

② RailGuard 200™ Safety Guardrail



Non-penetrating weighted bases and guardrail prevents people from falling.

- Non-penetrating, maintains a water tight roof
- No tools or drilling required
- A wide selection of accessories available

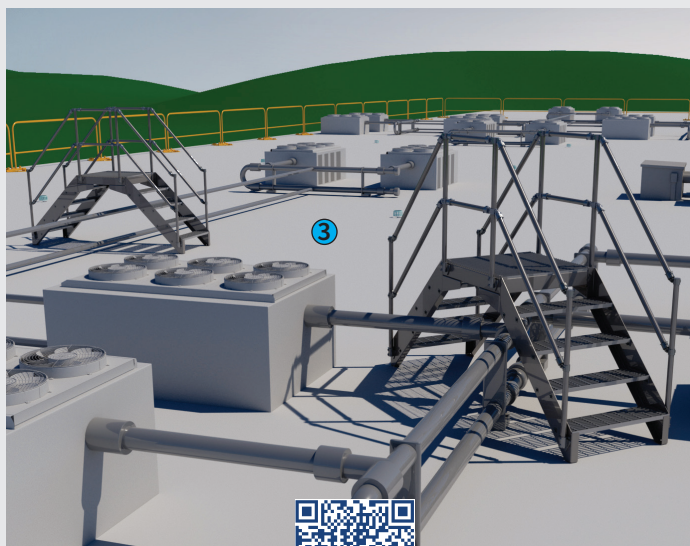

③ Crossover Stairs



Crossover stairs provide a safe way to move over obstacles and prevent trip and fall injuries.

- Modular design bolts together quickly
- From two to seven treads in height and up to three 36" platforms long for wide obstacles
- Heavy-duty steel components and galvanized for long life



④ SentryGuard™ Gates



SentryGuard is the perfect solution for protecting shipping and receiving dock doors.

- Operation assisted by gas struts for easy lifting
- Single opening gates for openings 3 ft. to 10 ft. wide
- Split gates for openings up to 14 ft. wide

